

Hammer In Fixings



WW

A countersunk, ribbed plug manufactured from PA6 nylon and fitted with a Zinc Plated drive screw. Suitable for use in Concrete, Brick, Concrete Blocks, & Natural Stone. Restricted use in Hollow bricks and blocks and Aerated Concrete Blocks

Range Information

Product Code	Plug Size	Drill Hole Diameter mm	Min. Hole Depth mm	Plug Length mm	Screwdriver Bit Size	Max Fixture Thickness mm	Unit Qty
070-140-015	5 x 40	5	30	40	2	15	200
070-140-024	6 x 40	6	35	40	2	15	200
070-140-035	6 x 60	6	35	60	2	35	200
070-140-038	6 x 70	6	35	70	2	40	100
070-140-040	8 x 60	8	50	60	3	20	100
070-140-045	8 x 80	8	50	80	3	40	100
070-140-050	8 x 100	8	50	100	3	60	100
070-140-055	8 x 120	8	50	120	3	80	100
070-140-070	10 x 100	10	60	100	3	60	50
070-140-075	10 x 120	10	60	120	3	80	50
070-140-080	10 x 135	10	60	135	3	95	50
070-140-085	10 x 160	10	60	160	3	115	50

Hammer in fixings are suitable for use in most solid base materials ranging from reinforced concrete, concrete blocks, brickwork and natural stone. They can also be used in Aerated Concrete Blocks, but their load capacity will be limited by the strength of the block. They can also be used in Hollow Base Materials but their use will be restricted by the thickness of the wall of the brick or block.

Olympic Fixing Products Ltd

The Globe Centre, Suite 7, St James Square, Accrington BB5 0RE

Tel: 01282 778923

accrington@olympicfixings.co.uk

www.olympicfixings.com

Company Registration No: 02367267

VAT Registration No: GB 572277230

Olympic Fixings Ireland Ltd

Unit 3, Greenway Industrial Estate Conlig, Co. Down BT23 7SU

Tel: 02891 453724

bangor@olympicfixingsireland.com

www.olympicfixings.com

Company Registration No: 02666419

VAT Registration No: GB 598063891

Quality products from the fixing specialists

Typical Applications:

- Timber Battens
- Frame Ties
- Electrical Boxes
- Suspended Ceiling Trim
- Conduit clips

Installation Instructions:

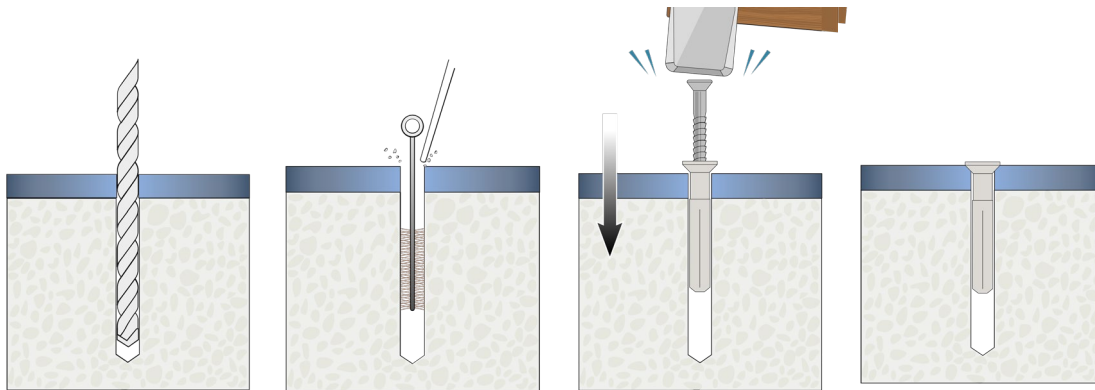

1. Drill correct diameter hole through fixture to correct depth in base material.
2. Clean hole by brushing and blowing
3. Insert Hammer in fixing through fixture into base material and hammer screw into plug.

Olympic Fixing Products Ltd

The Globe Centre, Suite 7, St James Square, Accrington BB5 0RE

Tel: 01282 778923

accrington@olympicfixings.co.uk

www.olympicfixings.com

Company Registration No: 02367267

VAT Registration No: GB 572277230

Olympic Fixings Ireland Ltd

Unit 3, Greenway Industrial Estate Conlig, Co. Down BT23 7SU

Tel: 02891 453724

bangor@olympicfixingsireland.com

www.olympicfixings.com

Company Registration No: 02666419

VAT Registration No: GB 598063891